

SYMBOL	REVISION REQUIRED	DATE	AUTH.
A	Add Tolerances & Notes	10/1963	H.F.O.
B	Circle on Glass was .220" Ø	8/25/2004	D.B.O.
C	Redrawn, revised notes	4/20/2005	D.B.O.

Notes:

- All Dimensions in inches
- SENSITIVITY:** 45 minutes / .1" movement of the bubble
Tolerance on sensitivity is $\pm 10\%$.
- Part or all of the finish maybe removed from Surface "X" during calibration

MATERIAL: Housing: Brass
Vial: Glass

FINISH on Housing: Chrome Plate

FLUID: Clear Mineral Spirits

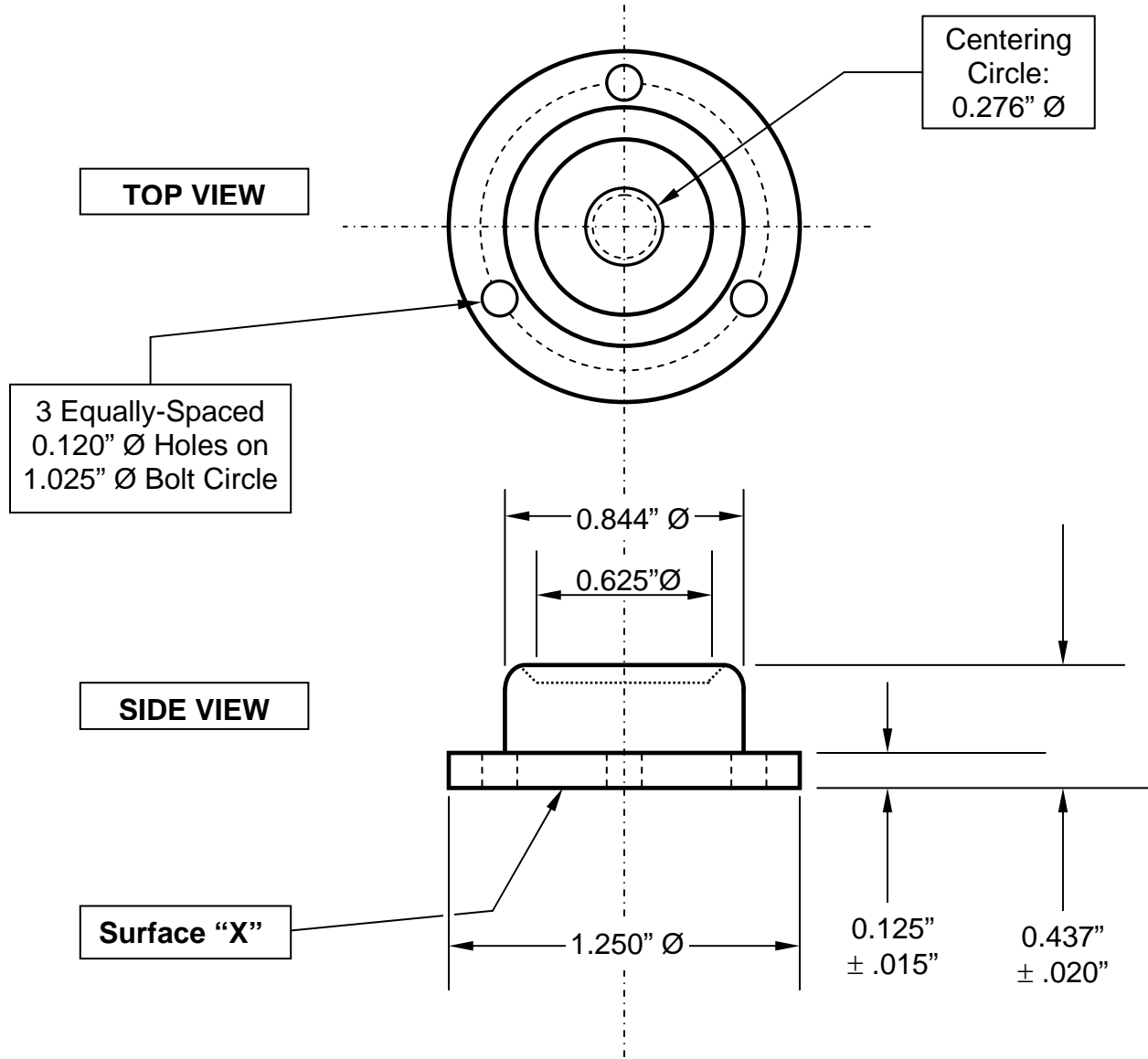

Tolerances: (except as noted) **Decimal $\pm .010"$** **Fractional $\pm 1/64"$** **Angular $\pm 1^\circ$**

GEIER & BLUHM, INC. 594 River Street Troy, NY 12180 USA	DRAWN BY: DAVID OSTER	DATE: December 17, 1959
	Scale: NONE	DRAWING NUMBER
	MOUNTED CIRCULAR LEVEL	2-12000